

24 x 60

Office Complex

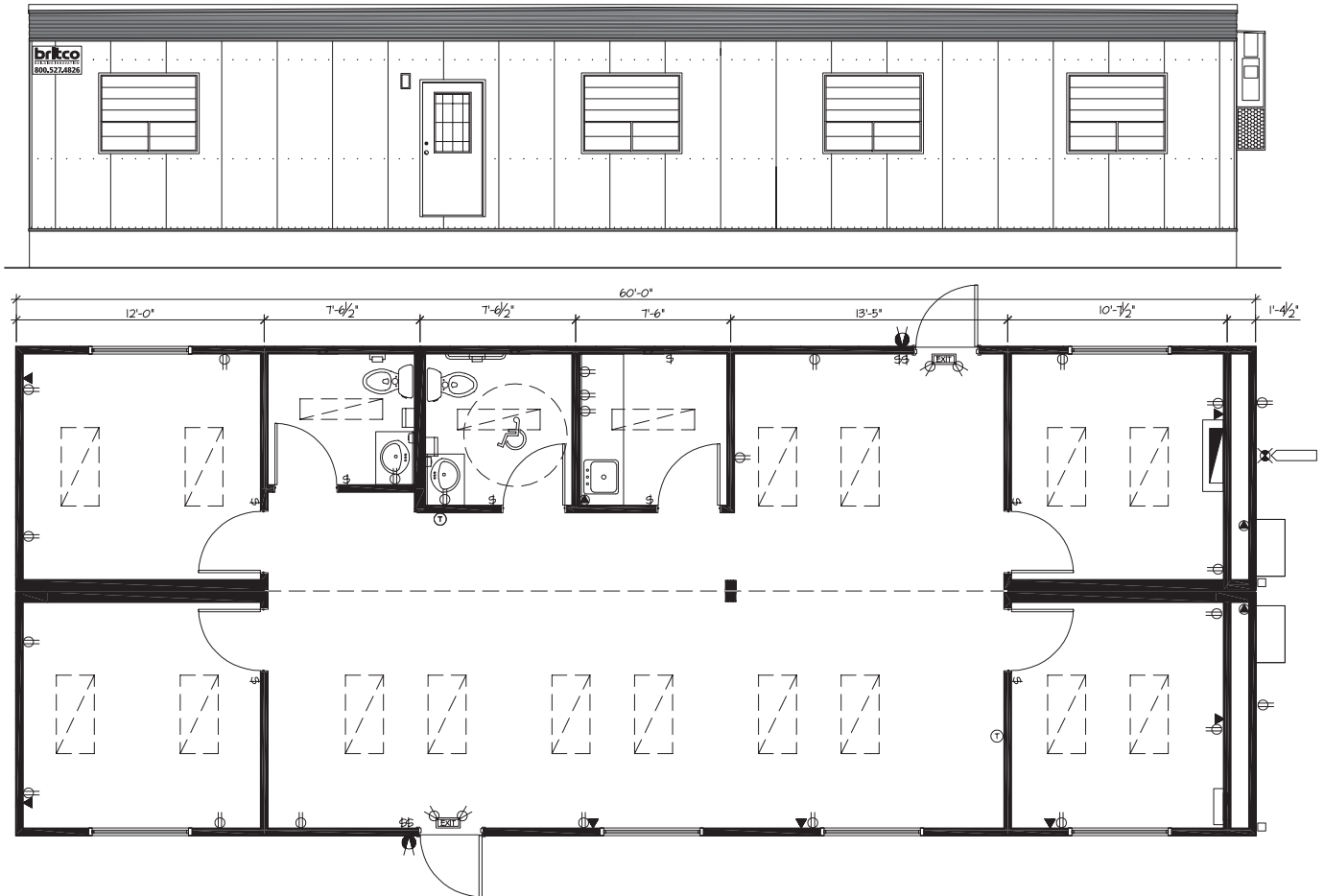

General Specifications

Exterior Siding:	Metal siding & metal fascia	Roof:	EPDM (rubber) roofing
Interior Walls:	Vinyl-clad gyproc (Norwich Pearl)	Heating/Cooling:	Electric forced-air furnace "BARD" HVAC unit (exterior wall-mounted) with T-Bar ducting
Windows:	5'-0" x 4'-0" O/XO horizontal slider with insect screens & security bars	Lighting:	Fluorescent lights, 4-bulb, recessed; Exterior lights
Exterior Doors:	Hollow metal insulated door with half-lite window, passage set, deadbolt and check chain	Electrical:	120/240 volt single phase, mast & weatherhead, 400 amp main beaker (demand load: 100 amp) electrical panel, duplex wall receptacles, tel/data conduits (jacks & wiring not included)
Interior Doors:	Hollow-core door, prefinished wood with passage set	Plumbing:	Washroom: toilet & sink (H/C accessible); Kitchen: 7' counter with cabinets, stainless steel sink & 2 gal. electric hot water tank
Floor:	Vinyl-composite tile (commercial grade)		
Ceiling:	T-Bar suspended ceiling		